

Winkhaus Thunderbolt Heritage

Created for Security and fashion, designed to complement the modern or traditional door



in
Doors



Winkhaus Thunderbolt Heritage

Created for Security and fashion, designed to complement the modern or traditional door

Modern Multi-Point Locking systems which provide higher levels of security and weather performance have traditionally not leant themselves to be used with ornate or architectural long bar pull door furniture and separate eye-level escutcheon which can be so common on Georgian and Edwardian doors and are now a fashion choice of consumers choosing a contemporary styled Timber or composite door.

The Thunderbolt Heritage is a Key Turn Activated Locking System which houses the euro profile locking cylinder at a similar height to a traditional round cylinder pull giving both the fabricator and the consumer a secure solution that also help to add “visual value” and style to their door.

The product like all of the Thunderbolt range features twin deadbolts in the upper and lower positions and the product features **5 deadbolts** as standard.

The locking system is designed to technically complement doors made from all materials and it is especially competent when used with timber doors. The twin deadbolt design has up to 50% greater fitting tolerances and also allows for greater material movement associated with certain hardwoods.

The product also features a new ultra smooth Key Turn Activated gearbox. Designed and manufactured in Germany after an extensive Research and Development programme the lock is operated by turning the key 720° clockwise or anti-clockwise to simultaneously engage or disengage both the 20mm throw nickel plated alloy twin deadbolts and the nickel plated steel central deadbolt. The engineered alloy sprung latch can be disengaged by a further key turn.

Designed to complement a contemporary or traditional period door the product can be used with a period style ornate pull or a contemporary long bar handle and it especially dovetails well when used with the High Security Winkhaus Heritage Pull.



The security nickel plated steel twin deadbolts fully penetrate the heavy duty steel keeps and help prevent forcing apart of the door and frame. Thunderbolt Heritage is Police Secured By Design and PAS 24.



The high performance Key Turn Activated gearbox is tested to 100,000 cycles and offers the lowest possible operating forces.



Tested to PAS 24 the Thunderbolt Heritage twin deadbolts provide low operating forces and helps doors achieve a higher level of weather performance.



Winkhaus locks have a protective surface coating in excess of EN 1670 : 2007 Grade 4 which is designated as ‘Very high corrosion resistance’.



Thunderbolt Heritage has been designed to harmonise with the Winkhaus XR6-51 Kitemark profile cylinder (KM531333) and in combination with a security escutcheon meets PAS 24 and the highest TS007 3☆ security requirements.

A Highly Engineered Gearbox

- + New and improved Smooth locking and unlocking via cylinders
 - + Vastly increased tolerance and strength of internal gear mechanism
 - + Internal Gears sintered with new materials used to ensure improved surfaces and edges on the gear teeth surface
 - + Easy operation low force latch and deadbolt retraction
 - + 30% increase in overall gearbox strength and durability
 - + A fully encased gearbox that eliminates the possibility of swarf entering the gearbox and affecting the smooth operation of the gears
 - + With integral screw holes to receive security escutcheon and/or bolt through handles
-

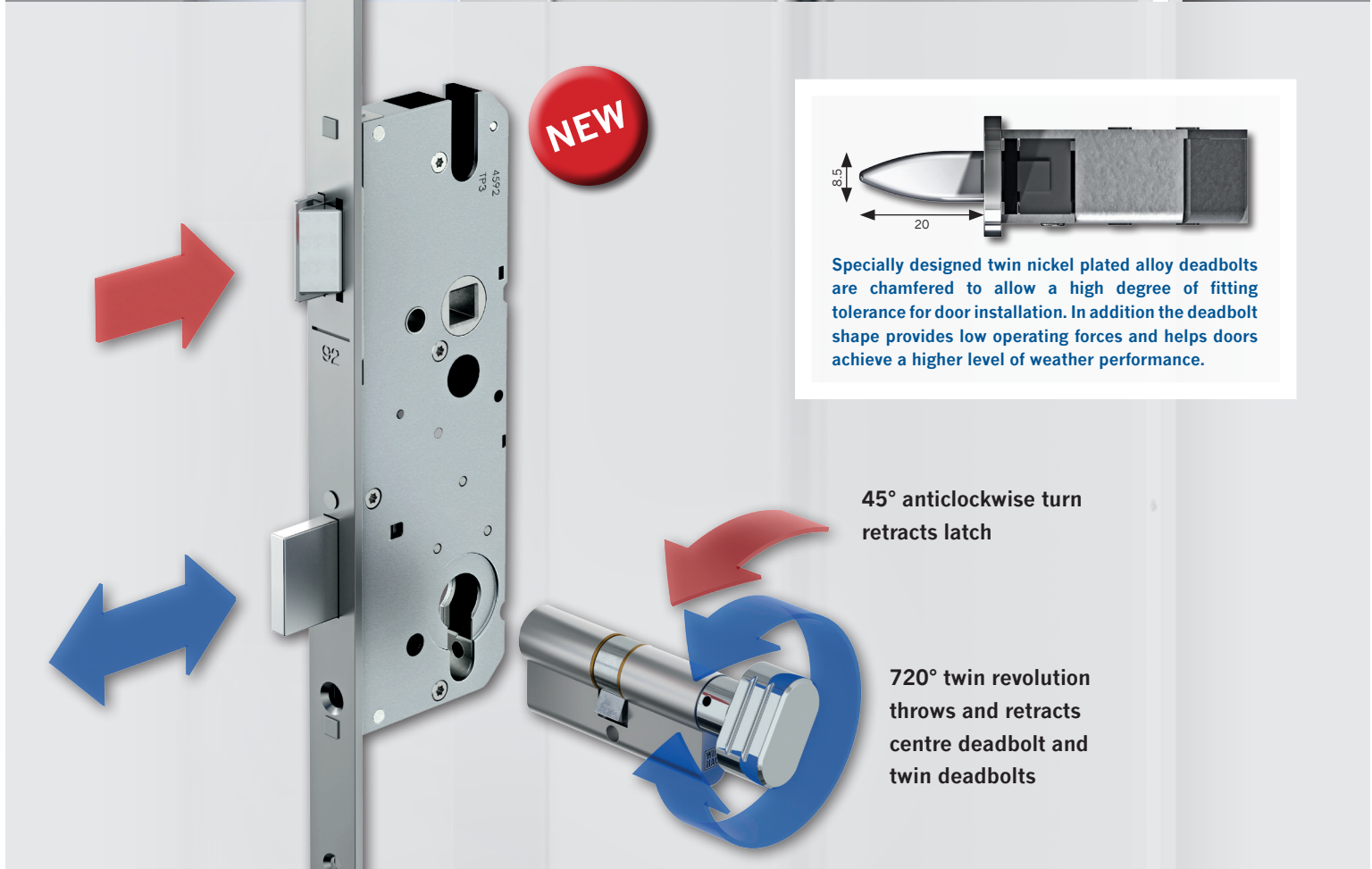

Winkhaus UK Ltd

2950 Kettering Parkway, Kettering,
Northants NN15 6XZ

Tel: +44 (0)1536 316000

Fax: +44 (0)1536 416516

www.winkhaus.co.uk

email: enquiries@winkhaus.co.uk